

JOIN THE FUTURE OF CHEROKEE SOUTH

Located at 95th Street and Antioch Road in Overland Park, Kansas



2009 REDEVELOPMENT



Cherokee South Plaza is a 111,294 square foot neighborhood retail center located in Johnson County's Overland Park, Kansas. Situated on the southwest corner of 95th Street and Antioch Road, over 60,000 vehicles pass this site on a daily basis.

- 3.0 mile population - 100,000
- 3.0 mile average income - \$84,000
- Highly Visible from both Antioch and 95th Street
- 4-Way interchange (435) and Antioch
- Stoplight intersection
- Redevelopment Plans include a new building façade, repaved parking lot, new building and site signage, high-impact landscaping and high-intensity lighting
- Join this highly anticipated redevelopment project



For Leasing information call: 1-800-441-7032

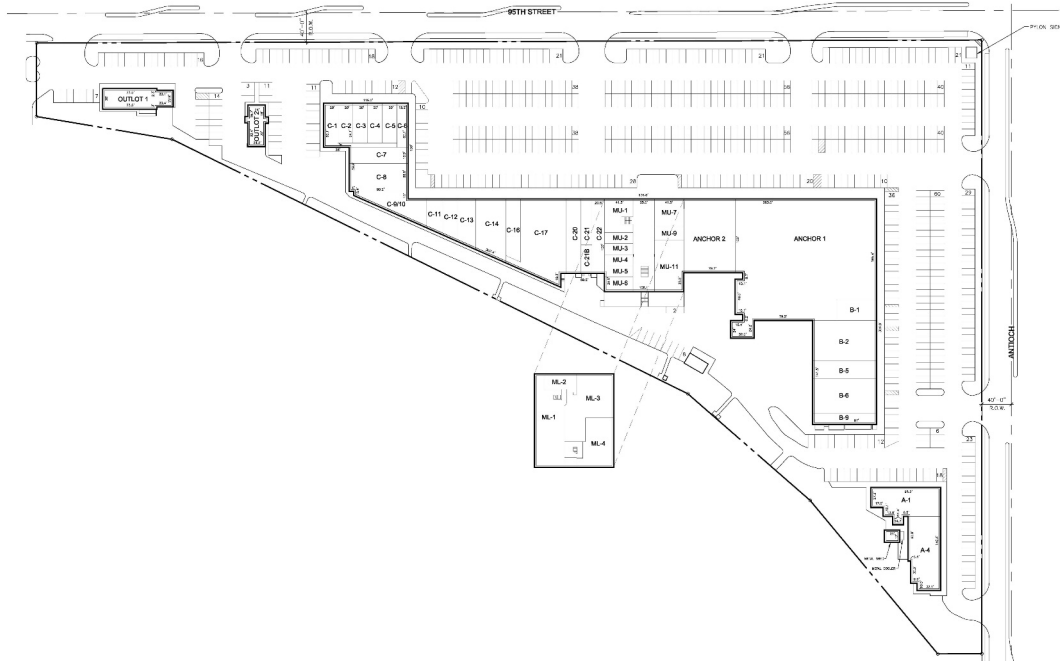

JOIN THE FUTURE OF CHEROKEE SOUTH

Located at 95th Street and Antioch Road in Overland Park, Kansas

Proposed Site Plan

